

2015

PARTS CATALOG

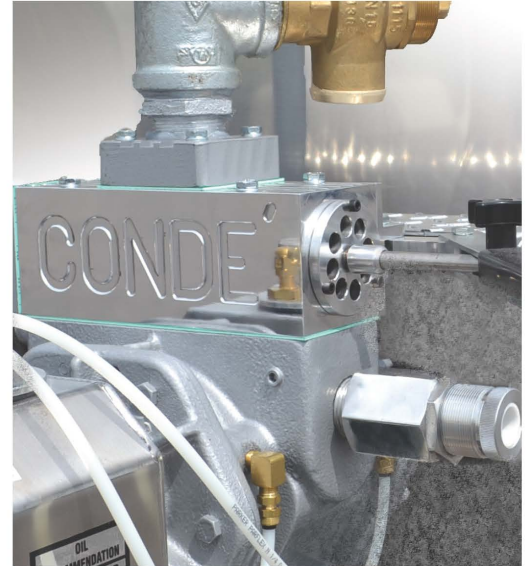

o n e  s o u r c e



GLOBAL™ MAJOR ASSEMBLY

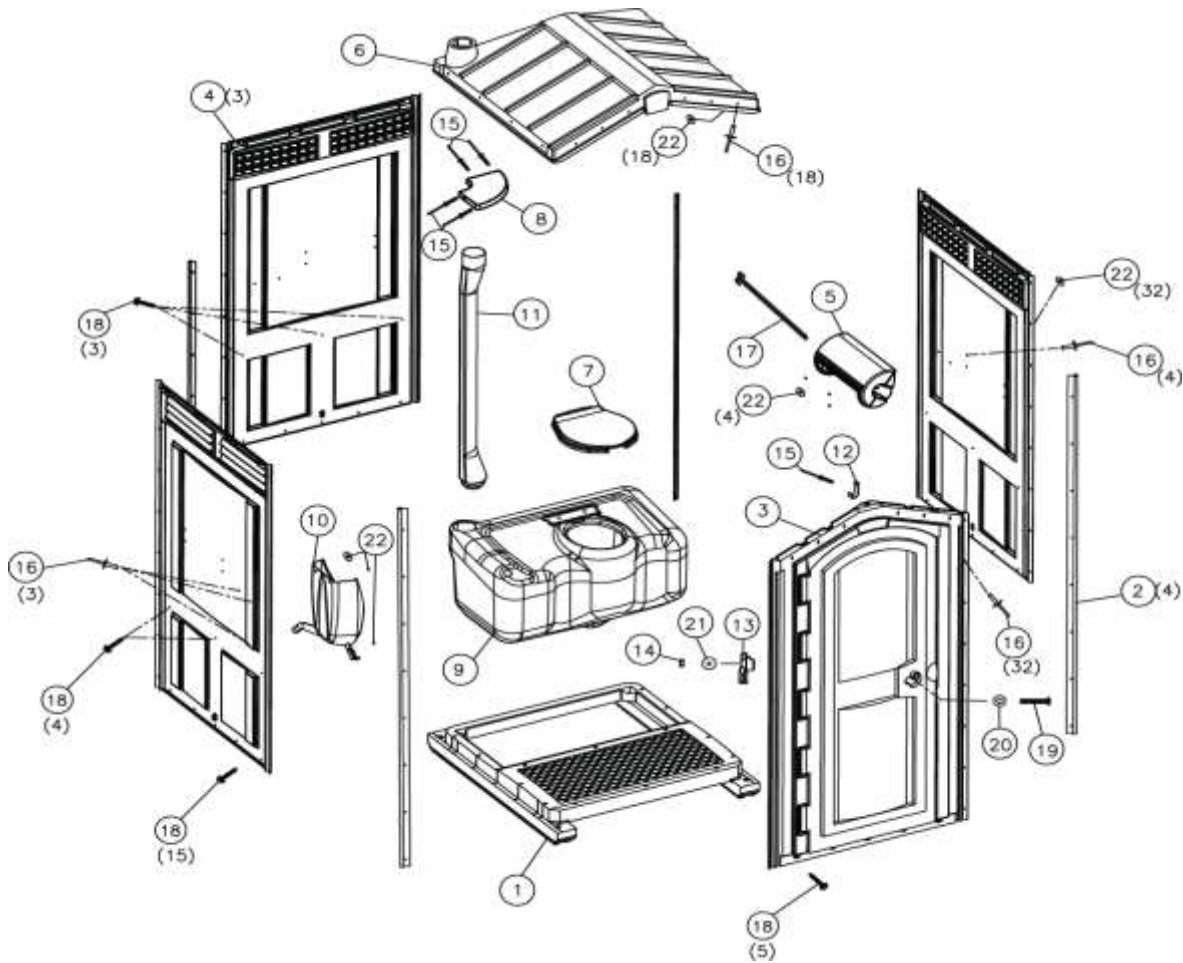

GLOBAL™ COLOR CHART

	ITEM	BLUE	GREEN	TAN	GREY	YELLOW	RED	ORANGE
FRONT GB	Door	40007	40008	40009	40010	40011	40012	40013
PANEL GB	Panel	40000	40001	40002	40003	40004	40005	40006

CUSTOM COLORS (QTY 55 – 4 TO 6 WEEKS LEAD TIME FROM ORDER RELEASE)

CONTACT AREA MANAGERS FOR PRICING

	CUSTOM
	AQUA
FRONT GB	40069
PANEL GB	40068

GLOBAL™ MAJOR ASSMBLY

GOES WITH	REV D ITEM#	PART#	QTY PER UNIT	DESCRIPTION	PRICE EACH
	1	40014	1	BASE- GB DIRT BUSTER	
	2A	40020	4	EXTRUSION- GB T DRILLED BLACK	
	2B	40019	4	EXTRUSION- GB HD DRILLED GREY	
	3	SEE COLOR	1	FRONT ASSY- GB	
2A		40083	1	KIT- GB T EXT HDWE ADD ON	
2B		40084	1	KIT- GB HD EXT HDWE ADD ON	
	4	SEE COLOR	3	PANEL- GB	
	5	NOT SALEABLE	1	PAPER HOLDER- GB 3R	
	6	40016	1	ROOF- GB NATURAL	
	7	10570	1	SEAT- TOILET BLACK (INCLUDES HARDWARE - 10 PER CASE)	
		14959	1	SEAT- ELONG MX2/MX3/TRS/HT/GB BLK (OLD TANKS PRE 05-11)	
		19196	1	KIT- T/SEAT 2-1/2 BOLT/NUT SET	
	8	NOT SALEABLE	1	SHELF- GB	
	9	40017	1	TANK- GB DGRY (2011)	
	10	NOT SALEABLE	1	URINAL- GB (MOUNTS TO FRONT OF TANK)	
		21638	1	KIT- GB URINAL SPLSHGUARD DGRY	
	11	NOT SALEABLE	1	VENT PIPE- GB	
		40022	1	HDWE- GB	
	12	10891	1	HOOK- FLAT COAT STNLS	
	13	40057	1	HANDLE- GB TOILET GREY	
	14*	16307	1	NUT- GB 1/4-20 NYLON LOCK	
	15*	17436	5	RIVET- AVDEL SILVER	
	16*	11030	25	RIVET- #66 AAL POP	
	17	40059	1	ROD- GB PAPER HOLDER 3R SS	
	18*	13860	27	SCREW- # 14 X 1 - 1/2 W/WSH GOLD	
	19	40052	1	SCREW- GB 1/4 - 20 ROUND HEAD	
	20*	11360	1	WASHER- 1/4 ID FENDER STNLS	
	21*	12382	1	WASHER- 1/4 FLAT STNLS	
	22*	11315	25	WASHER- 3/16 RIVET STNLS	
		40085	1	FLOOR OVERLAY- 20-7/8 x 40-1/2 (FITS NEW)	
		40086	1	FLOOR OVERLAY- 22 x 40-1/2 (FITS PRE 2011)	
		40044	9	SCREEN- GB VENT	
		40088	1	KIT- GB OLD SCREENS/RIVETS (2 RIVET HOLES) qty 9	
		17224	1	URINAL PLUG- 1-5/8 ROUND HOLE	
		40112		INSTRUCTIONS GB T EXT 505 TNK (NOT SHOWN)	
		40116		INSTRUCTIONS GB HD EXT 505 TNK (NOT SHOWN)	

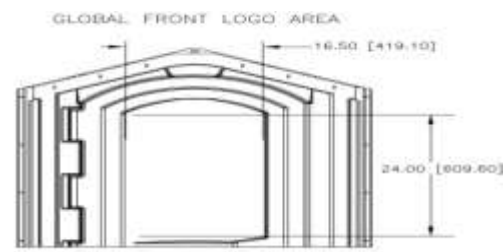
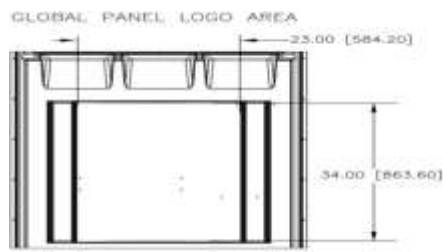

Consult Your Area Manager at:

Tel: 1-800-883-1123 (US & Canada) Fax: 1-800-328-3334 (US & Canada)

Web Site: www.satelliteindustries.com

GLOBAL™ FRONT ASSEMBLY

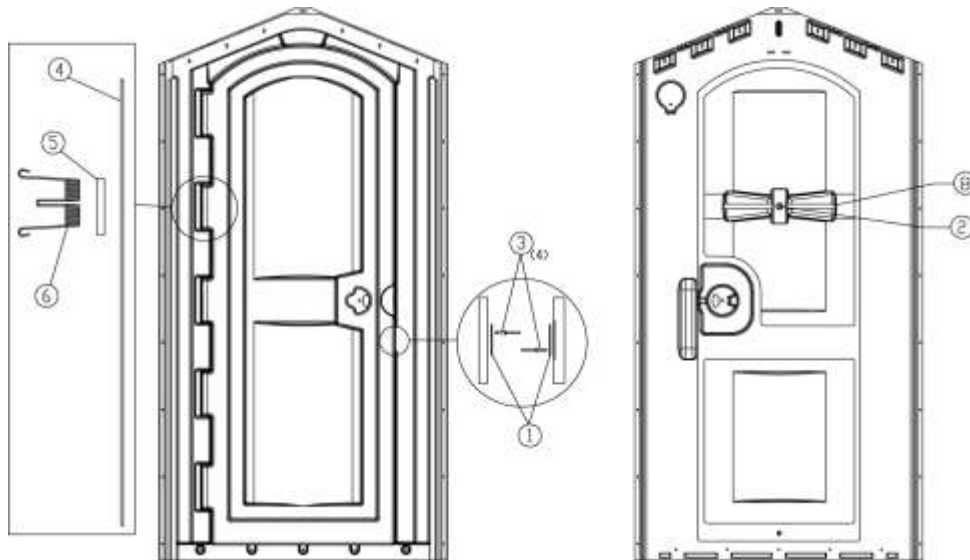

REV B Item #	PART #	QTY PER UNIT	DESCRIPTION	PRICE EACH
1	40140	2	HASP- GB FRONT	
2*	11054	1	RIVET- #68 AAL POP	
3	17436	4	RIVET- AVDEL SILVER	
4	40148	1	ROD- GB FRONT	
5	40150	1	ROD SLEEVE- GB FRONT SPRING	
6	40110	1	SPRING- GB FRONT	
7	11261	1	TIE- WIRE 6in	
8	40104	1	TUBE- GB FRONT HANDLE	

REV B Item #	PART #	QTY PER UNIT	DESCRIPTION	PRICE EACH
	40102	1	KIT-GB DOOR SPRING PRE 2005	
	40109	1	INSTRUCTION- GB SPRING PR/2005 (NOT SHOWN)	

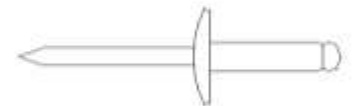
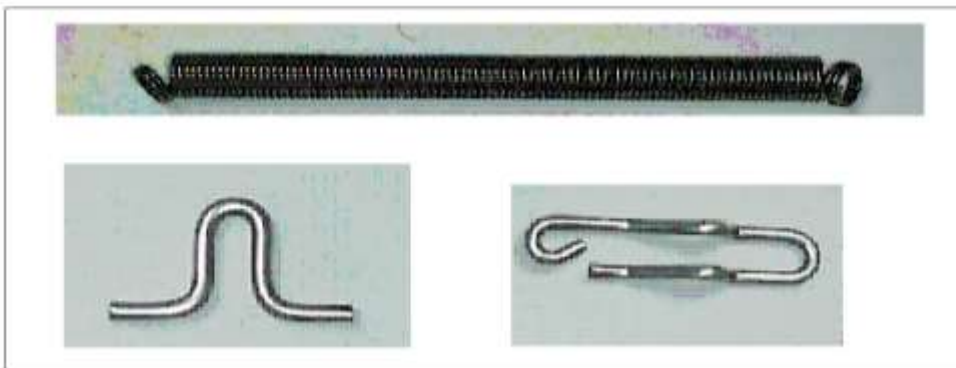

Visa / Mastercard / American Express / Discover

\$25.00 Minimum Order — Prices and quantities subject to change / all prices are FOB FACTORY — Priced in U.S. Dollars
20% minimum restocking charge applies on returns

Area Managers & Territories

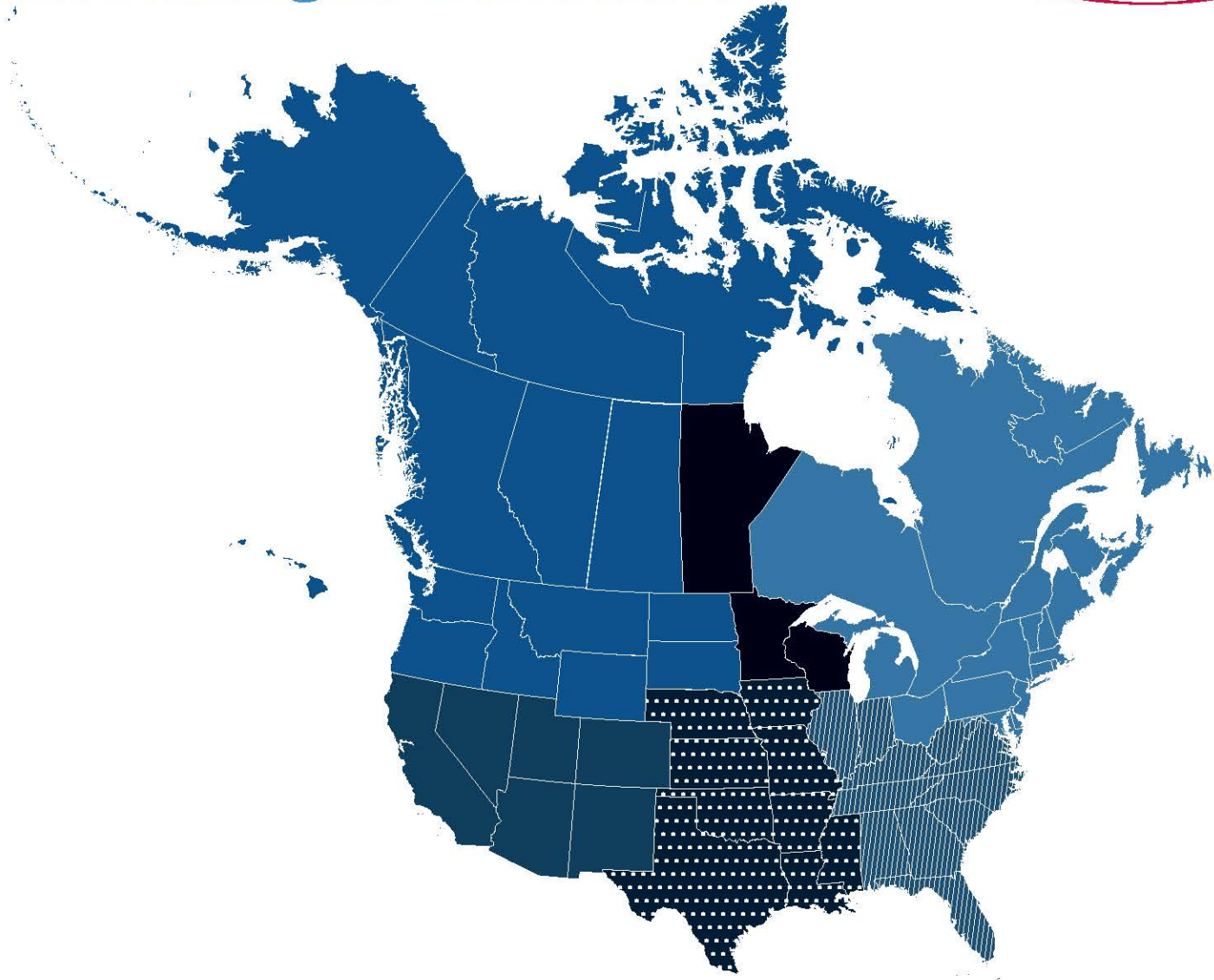

Northwest

John Sprenger

800.824.5755 / johns@satelliteco.com



Southwest

Tim White

800.272.3280 / timw@satelliteco.com



South Central

Gene Clay

866.556.4630 / genec@satelliteco.com



Northeast

Deric Boggs

800.328.2331 / dericb@satelliteco.com



Southeast

Ryan Anthony

877.711.1054 / ryana@satelliteco.com



MN, WI & Manitoba

Mark Elhardt

800.328.3332 / marke@satelliteco.com

Online Ordering

satelliteindustries.com

safetfresh.com

Customer Service

Restrooms: 800.883.1123 | Fax: 800.328.3334

Safe-T-Fresh: 877.764.7297 | orderdesk@satelliteco.com