

# 2016

## PARTS CATALOG



o n e  s o u r c e



## HELPFUL PARTS ORDERING TIPS

### ORDERING TIPS

- Consolidate parts orders to save you time and reduce overall shipping costs.
- Maintain a limited stock of “emergency” type parts to eliminate down time and air shipment expense. A sample of recommended parts:
  - Truck Part: Vacuum pump belt and pump repair kit
  - Accessory Part: Whale Pump Repair Kit (sink part)
  - Restroom Part: Toilet Seat Hardware Kit
  - Deodorizer: 1 Container of Tank Deodorizer & Fragrance Spray in reserve

### RECEIVING TIPS

1. Let us know when you need your order to arrive.
2. Advise us if you prefer delivery appointments for your less than truckload shipments.
3. Count packages and check their condition prior to signing for the goods.
4. Make note on carrier paperwork regarding any shortage or damage.

### ORDERING INFORMATION

Location	Phone	Fax	Email
USA/Canada	800-883-1123	800-328-3334	orderdesk@satelliteco.com
Outside USA/Canada	763-553-1900	763-551-7246	

Customer Service Hours: 8:00 - 5:00 pm (Central Standard Time)

NOTE: PARTS MAY SHIP FROM MULTIPLE LOCATIONS. COMPONENT PARTS SHIP WITHIN 3 BUSINESS DAYS LTL OR UPS.

### GLOBAL 1.5™ MAJOR ASSEMBLY

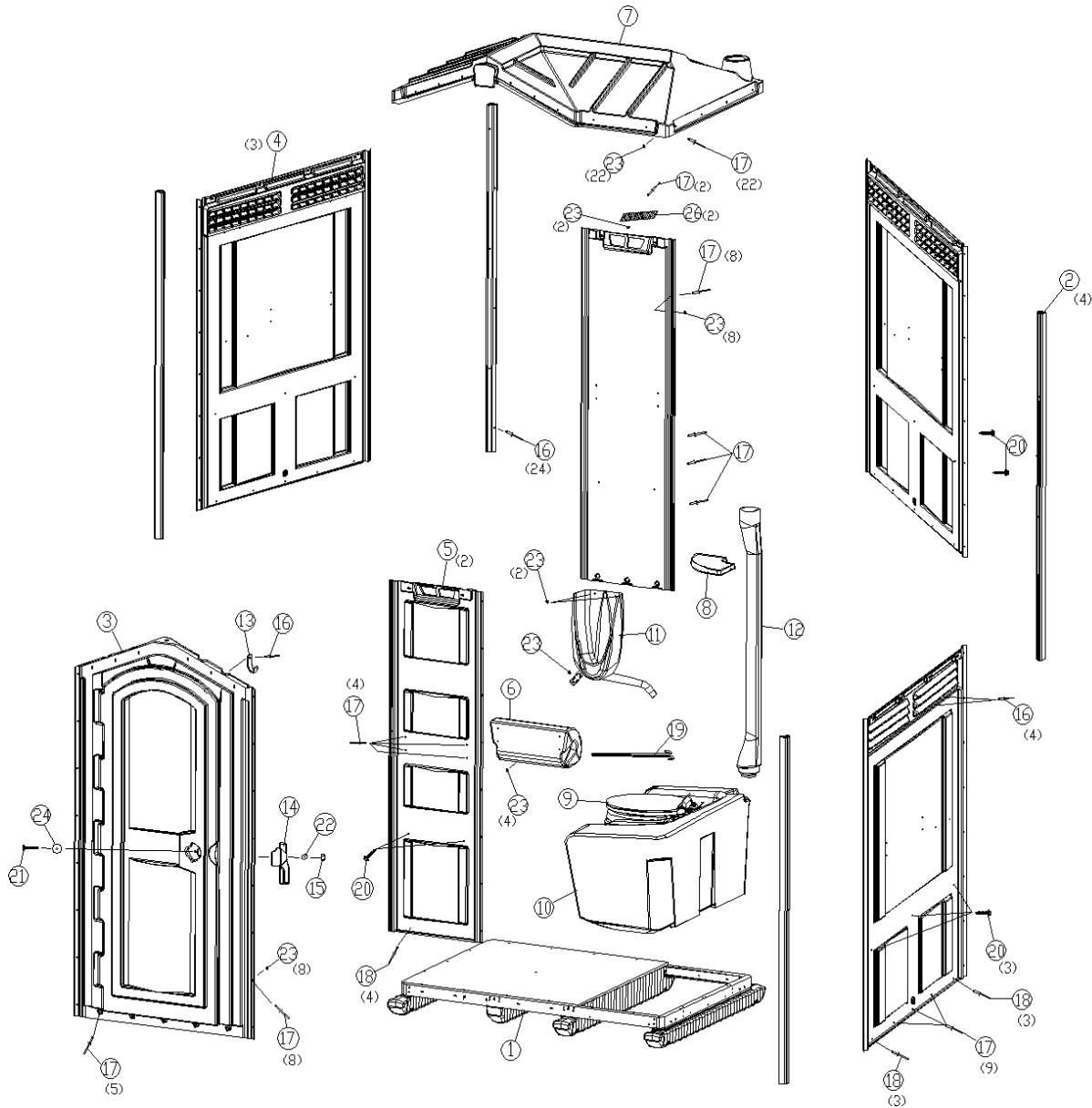

### GLOBAL 1.5™ COLOR CHART

DESCRIPTION	ITEM	BLUE	GREEN	TAN	GREY
FRONT ASSY- GB	Door	40007	40008	40009	40010
PANEL GB	Panel	40000	40001	40002	40003
½ PANEL GB	½ Panel	40078	40079	40080	40081

Visa / Mastercard / American Express / Discover – A 3% fee for any orders charged over \$15,000.00 will apply.  
 \$25.00 Minimum Order — Prices and quantities subject to change / all prices are FOB FACTORY — Priced in U.S. Dollars  
 20% minimum restocking charge applies on returns

## GLOBAL 1.5™ MAJOR ASSEMBLY

REV B ITEM#	PART#	QTY PER UNIT	DESCRIPTION	PRICE EACH
1	40074	1	BASE- GB 1.5	
2	40019	4	EXTRUSION- GB HD DRILLED GREY	
	21226	4	RUNNER- 1.5 BASE W/HDWE SET/4	
3	SEE CHART	1	FRONT ASSY GB	
	40103	1	HDWE- GB 1.5	
4	SEE CHART	3	PANEL- GB	
5	SEE CHART	2	PANEL HALF- GB 1.5	
6	NOT SALEABLE	1	PAPER HOLDER- GB	
7	40075	1	ROOF- GB 1.5 NATURAL	
8	NOT SALEABLE	1	SHELF- GB	
9	10570	1	SEAT- TOILET BLACK (INCLUDES HARDWARE - 10 PER CASE)	
10	40017	1	TANK- GB 505 W/SEAT ROTO	
11	NOT SALEABLE	1	URINAL- GB	
	21638	1	KIT- GB URINAL SPLSHGUARD DGRY	
12	NOT SALEABLE	1	VENT PIPE- GB	
13	10891	1	HOOK- FLAT COAT STNLS	
14	40057	1	HANDLE- GB TOILET GREY	
15*	16307	1	NUT- 1/4-20 NYLOC STNLS	
16*	17436	29	RIVET- AVDEL SILVER	
17*	11054	61	RIVET- #68 AAL POP	
18	40106	1=10	RIVET- GB 3/16 S/FLANGE BULBEX	
19	40059	1	ROD- GB PAPER HOLDER 3R SS	
20	13860	7	SCREW- #14 X 1-1/2 W/WSH GOLD	
21	40052	1	SCREW- 1/4-20x3-1/2 PH PNHD SS	
22*	12382	1	WASHER- 1/4 FLAT STNLS	
23*	11315	47	WASHER- 3/16 RIVET STNLS	
24	11360	1	WASHER- 1/4 ID FENDER STNLS	
25	40147	1	INSTRUCTION- GB 1.5 HD	
26	40044	2	SCREEN- GB VENT	

\* ONLY SOLD IN MULTIPLES OF 100

Consult Your Area Manager at:

Tel: 1-800-883-1123 (US &amp; Canada) Fax: 1-800-328-3334 (US &amp; Canada)

Web Site: [www.satelliteindustries.com](http://www.satelliteindustries.com)

## PARTS ORDER FORM

Photocopy for use as a fax form or visit us online 24/7 and place your parts orders for Satellite products at  
**SatelliteIndustries.com**

FAX TO CUSTOMER SERVICE AT #1-800-328-3334

EMAIL: [orderdesk@satelliteco.com](mailto:orderdesk@satelliteco.com)

PO #
COMPANY NAME:
BLL TO ADDRESS:
SHIP TO ADDRESS:
PHONE #

PART #	DESCRIPTION	ORDER QUANTITY	PRICE/UNIT	EXTENDED TOTAL

ORDERED BY	DATE	APPROVED BY (if NECESSARY)	DATE
------------	------	----------------------------	------

COMMENTS/SHIP-VIA/NEED-BY-DATE

---



---



---

VISA/ MASTERCARD / AMERICAN EXPRESS CARD #	
3 OR 4 DIGIT SECURITY CODE (on back of card)	
EXPIRATION DATE	CARD HOLDER NAME

# Our hidden strength is customer service... in person and online.



- Buy replacement parts online, anytime – 24/7
- As a Satellite or Safe-T-Fresh customer, you can manage your account online by viewing order history, account balances, shipping status and much more...
- Rest assured knowing your transactions are processed safely and securely on our private servers
- Find product information with full specifications, downloadable assembly sheets and helpful advice

VISIT OUR ONLINE STORES AT:



[satelliteindustries.com](http://satelliteindustries.com)



[safetfresh.com](http://safetfresh.com)



[satelliterestroomtrailers.com](http://satelliterestroomtrailers.com)



# Area Managers & Territories



## Northwest

**John Sprenger**

800.824.5755 / [johns@satelliteco.com](mailto:johns@satelliteco.com)



## Southwest

**Tim White**

800.272.3280 / [timw@satelliteco.com](mailto:timw@satelliteco.com)



## South Central

**Gene Clay**

866.556.4630 / [genec@satelliteco.com](mailto:genec@satelliteco.com)



## Northeast

**Deric Boggs**

800.328.2331 / [dericb@satelliteco.com](mailto:dericb@satelliteco.com)



## Southeast

**Ryan Anthony**

877.711.1054 / [ryana@satelliteco.com](mailto:ryana@satelliteco.com)



## MN, WI & Manitoba

**Mark Elhardt**

800.328.3332 / [marke@satelliteco.com](mailto:marke@satelliteco.com)

## Online Ordering

[satelliteindustries.com](http://satelliteindustries.com)  
[safetfresh.com](http://safetfresh.com)

## Customer Service

Restrooms: 800.883.1123 | Fax: 800.328.3334  
Safe-T-Fresh: 877.764.7297 | [orderdesk@satelliteco.com](mailto:orderdesk@satelliteco.com)